

## **TECHNICAL MANUAL / MANUAL TÉCNICO MANUEL TECHNIQUE / MANUALE TECNICO**

### **DW-ECO EI30**

- **EXTRACCIÓN DE CAMPANAS DE COCINAS INDUSTRIALES**

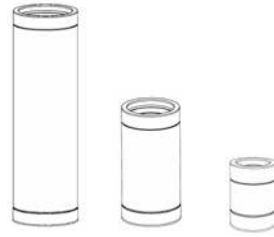

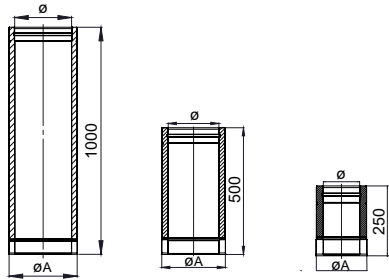

**Módulo recto**

1000 mm  
500 mm  
250 mm

DWECO13  
DWECO14  
DWECO15

Ø	130	150	180	200	250	300	350	400	450	500	550	600	650	700	750	800
ØA	180	200	230	250	300	350	400	450	500	550	600	650	715	765	815	865

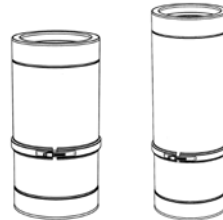
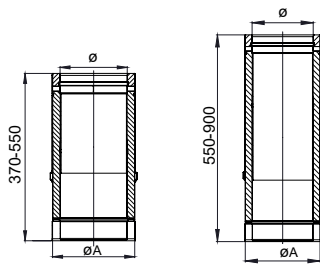

**Módulo recto regulable**

370 - 550 mm  
550 - 900 mm

DWECO544  
DWECO545

Ø	130	150	180	200	250	300	350	400	450	500	550	600	650	700	750	800
ØA	180	200	230	250	300	350	400	450	500	550	600	650	715	765	815	865

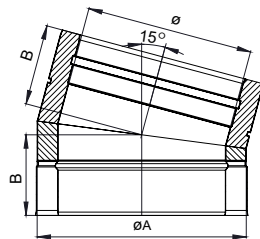

**Codo 15°**

DWECO16

Ø	130	150	180	200	250	300	350	400	450	500	550	600	650	700	750	800
ØA	180	200	230	250	300	350	400	450	500	550	600	650	715	765	815	865
B	92	93	95	96	100	103	106	110	113	116	120	123	126	129	133	136

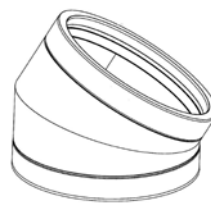
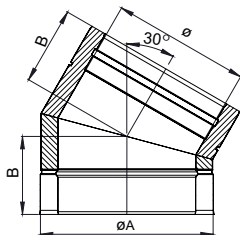

**Codo 30°**

DWECO17

Ø	130	150	180	200	250	300	350	400	450	500	550	600	650	700	750	800
ØA	180	200	230	250	300	350	400	450	500	550	600	650	715	765	815	865
B	104	107	111	113	120	127	134	140	147	154	160	167	176	182	189	196

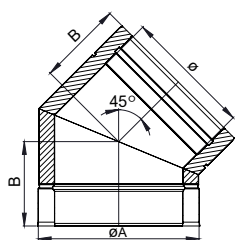

**Codo 45°**

**DWECO18**

<b>Ø</b>	130	150	180	200	250	300	350	400	450	500	550	600	650	700	750	800
<b>ØA</b>	180	200	230	250	300	350	400	450	500	550	600	650	715	765	815	865
<b>B</b>	117	121	128	132	142	152	163	173	184	194	204	215	228	238	249	259

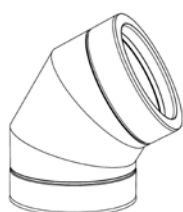
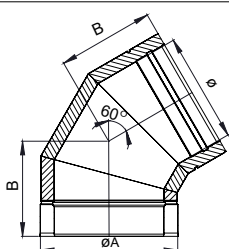

**Codo 60°**

**DWECO84**

<b>Ø</b>	130	150	180	200	250	300	350
<b>ØA</b>	180	200	230	250	300	350	400
<b>B</b>	155	161	169	175	190	204	219

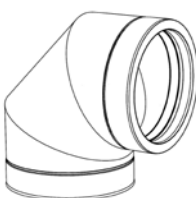
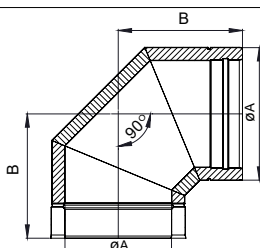

**Codo 90°**

**DWECO60**

<b>Ø</b>	130	150	180	200	250	300	350
<b>ØA</b>	180	200	230	250	300	350	400
<b>B</b>	198	208	223	233	258	283	308

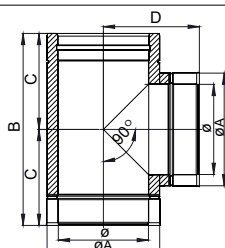

**Te 90°**

**DWECO317**

<b>Ø</b>	130	150	180	200	250	300	350	400	450	500	550	600	650	700	750	800
<b>ØA</b>	180	200	230	250	300	350	400	450	500	550	600	650	715	765	815	865
<b>B</b>	356	376	406	426	476	526	576	626	676	726	776	826	891	941	991	1041
<b>C</b>	178	188	203	213	238	263	288	313	338	363	388	413	446	471	496	521

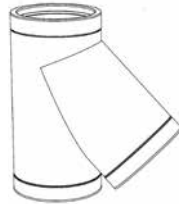
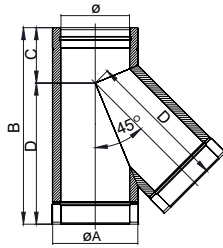

**Te 135°**

**DWECO12**

Ø	130	150	180	200	250	300	350	400	450	500	550	600	650	700	750	800
ØA	180	200	230	250	300	350	400	450	500	550	600	650	715	765	815	865
B	475	498	545	574	644	715	786	856	927	998	1069	1139	1231	1302	1373	1443
C	147	150	158	162	172	182	193	203	213	224	234	244	258	268	279	289
D	328	348	387	412	472	533	593	653	714	774	834	895	973	1033	1094	1154

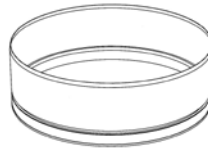
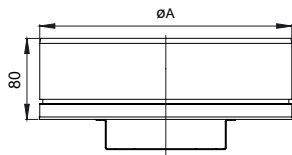

**Colector de hollín**

**DWECO551**

Ø	130	150	180	200	250	300	350	400	450	500	550	600	650	700	750	800
ØA	180	200	230	250	300	350	400	450	500	550	600	650	715	765	815	865

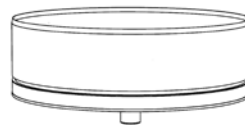
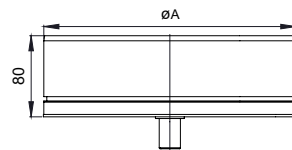

**Colector de hollín con desagüe**

**DWECO44**

Ø	130	150	180	200	250	300	350
ØA	180	200	230	250	300	350	400

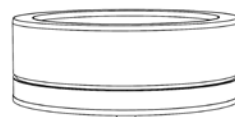
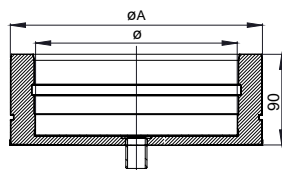

**Colector de hollín con desagüe aislado**

**DWECO1460**

Ø	130	150	180	200	250	300	350	400	450	500	550	600	650	700	750	800
ØA	180	200	230	250	300	350	400	450	500	550	600	650	715	765	815	865

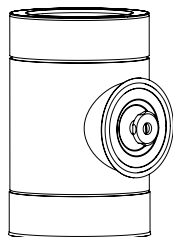
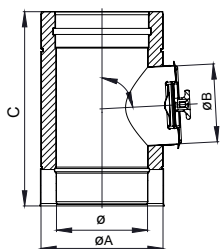

Mód. de inspección puerta 200 Pa (PI)

DWECO549

Ø	130	150	180	200	250	300	350	400	450	500	550	600	650	700	750	800
ØA	180	200	230	250	300	350	400	450	500	550	600	650	700	750	800	850
ØB	100	130					200									
C	330	360					500									

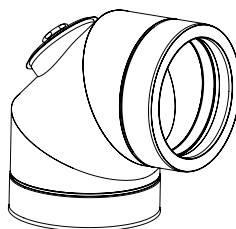
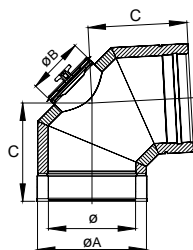

Codo 90° con puerta de inspección

DWECO67AL

Ø	130	150	180	200	250	300	350	
ØA	180	200	230	250	300	350	400	
ØB	100	130						
C	198	208	223	233	258	283	308	

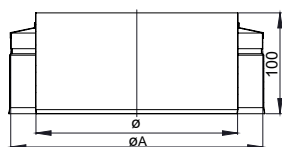

Terminal salida libre

DWECO32

Ø	130	150	180	200	250	300	350	400	450	500	550	600	650	700	750	800
ØA	180	200	230	250	300	350	400	450	500	550	600	650	715	765	815	865

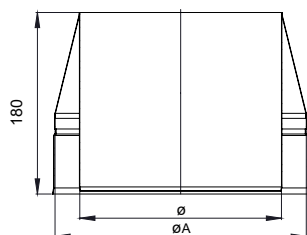

Terminal salida cónica

DWECO32C

Ø	130	150	180	200	250	300	350	400	450	500	550	600	650	700	750	800
ØA	180	200	230	250	300	350	400	450	500	550	600	650	715	765	815	865

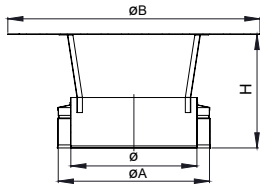

**Terminal anti-lluvia**

DWECO526

Ø	130	150	180	200	250	300	350	400	450	500	550	600
ØA	180	200	230	250	300	350	400	450	500	550	600	650
ØB	230	250	300	300	500	600	700	800	800	800	800	800
H	175	175	225	225	225	300	300	300	320	320	320	320

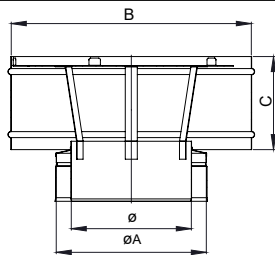

**Terminal anti-viento**

DWECO527

Ø	130	150	180	200	250	300	350	400
ØA	180	200	230	250	300	350	400	450
B	250	300	350	400	500	550	650	700
C	105	105	155	155	155	230	230	230

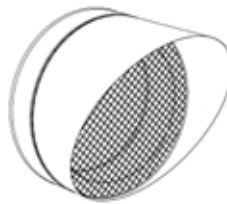
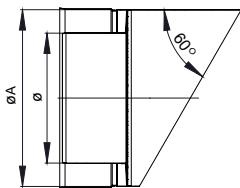

**Terminal horizontal con rejilla**

DWECO532

Ø	130	150	180	200	250	300	350	400	450	500	550	600	650	700	750	800
ØA	180	200	230	250	300	350	400	450	500	550	600	650	715	765	815	865

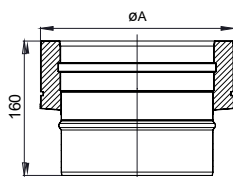

**Adaptador de simple a doble**

DWECO37

Ø	130	150	180	200	250	300	350	400	450	500	550	600	650	700	750	800
ØA	180	200	230	250	300	350	400	450	500	550	600	650	715	765	815	865

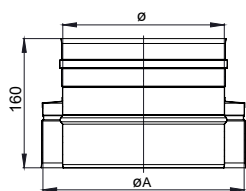

**Adaptador de doble a simple**

DWECO37A

Ø	130	150	180	200	250	300	350	400	450	500	550	600	650	700	750	800
ØA	180	200	230	250	300	350	400	450	500	550	600	650	715	765	815	865

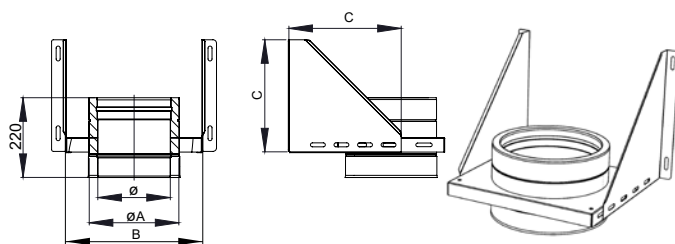

**Soporte de carga regulable**

DWECO379

Ø	130	150	180	200	250	300	350	400	450	500	550	600	650	700	750	800
ØA	180	200	230	250	300	350	400	450	500	550	600	650	715	765	815	865
B	305	325	355	375	425	475	525	575	625	675	725	775	825	875	925	975
C	265	265	295	310	360	410	460	510	560	610	660	710	760	810	860	910

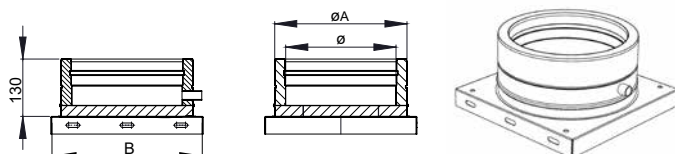

**Placa base desagüe lateral**

DWECO6

Ø	130	150	180	200	250	300	350	400	450	500	550	600	650	700	750	800
ØA	180	200	230	250	300	350	400	450	500	550	600	650	715	765	815	865
B	225	245	275	295	345	395	445	495	545	595	645	695	760	810	860	910

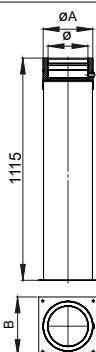

**Soporte base regulable**

DWECO4

Ø	130	150	180	200	250	300	350	400	450	500	550	600	650	700	750	800
ØA	180	200	230	250	300	350	400	450	500	550	600	650	715	765	815	865
B	225	245	275	295	345	395	445	495	545	595	645	695	760	810	860	910

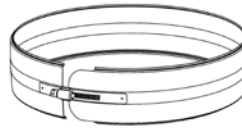
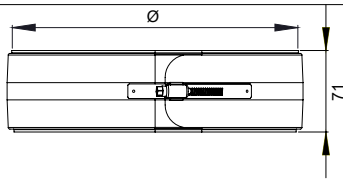

**Abrazadera de unión 2.0**

DW25989 - Ø130-Ø600  
DW32989 - Ø650-Ø800

Ø	130	150	180	200	250	300	350	400	450	500	550	600	650	700	750	800
ØA	180	200	230	250	300	350	400	450	500	550	600	650	715	765	815	865

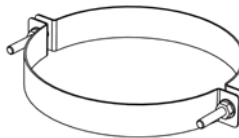
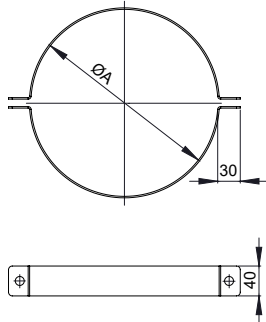

**Abrazadera de amarre por tornillo**

DW251063 - Ø80-Ø600  
DW321063 - Ø650-Ø800

Ø	130	150	180	200	250	300	350	400	450	500	550	600	650	700	750	800
ØA	180	200	230	250	300	350	400	450	500	550	600	650	715	765	815	865

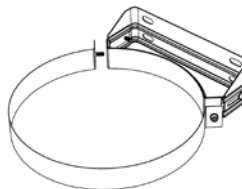
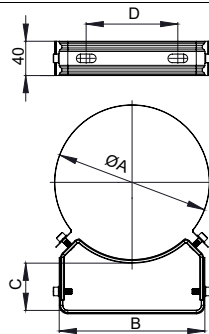

**Abraz. fijación pared regulable 50-75mm**

DW25556

Ø	130	150	180	200	250	300	350	400
ØA	180	200	230	250	300	350	400	450
B	164	181	205	217	252	287	346	358
C								
D	95	115	140	150	185	220	280	292

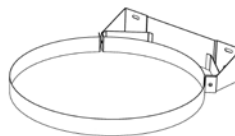
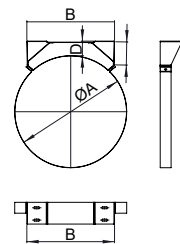

**Abrazadera fijación pared fija**

DW25556F - Ø450-Ø600  
DW32556F - Ø650-Ø800

Ø	450	500	550	600	650	700	750	800
ØA	500	550	600	650	715	765	815	865
B	444		500		550		650	
C	61	71	54	63	50	58	58	58



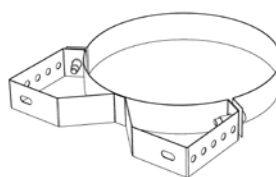
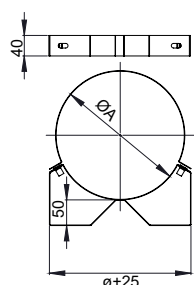

**Base de abrazadera distanciadora**

DW251462 - Ø80-Ø600

DW321462 - Ø650-Ø800

Ø	130	150	180	200	250	300	350	400	450	500	550	600	650	700	750	800
ØA	180	200	230	250	300	350	400	450	500	550	600	650	715	765	815	865

El sistema consta del cuerpo de la abrazadera, que es común para cada diámetro, y de cuatro modelos de alas. De tal modo que combinando el cuerpo de cada diámetro con cada uno de los modelos de alas se consiguen las distancias máximas de separación entre la pared y la parte posterior del conducto indicadas en la tabla de abajo (en mm). La distancia mínima en todos los casos es de 50mm.

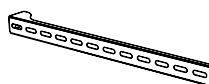
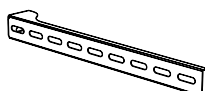
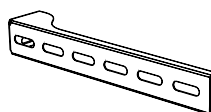
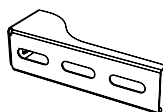
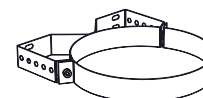
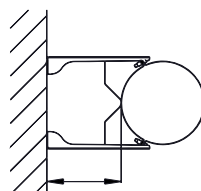
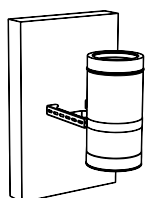

**Alas distanciadoras**

ZUWAA1462A

ZUWAA1462B

ZUWAA1462C

ZUWAA1462D

Nota: Estas abrazaderas no están diseñadas para soportar el peso de la chimenea, sino sólo para soportar las cargas laterales.

Ø	130	150	180	200	250	300	350	400	450	500	550	600	650	700	750	800
1462A	125	120	105	100	80	65	50									
1462B	275	270	255	250	230	215	200	175	150	135	110	85				
1462C	425	420	405	400	380	365	365	325	300	285	260	235	190	170	150	125
1462D	575	570	555	550	530	515	500	475	450	435	410	385	340	320	300	275

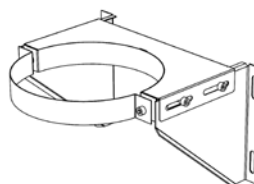
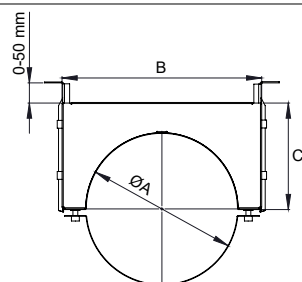

**Abrazadera de soporte**

DW25858 - Ø80-Ø600

DW32858 - Ø650-Ø800

Ø	130	150	180	200	250	300	350	400	450	500	550	600	650	700	750	800
ØA	180	200	230	250	300	350	400	450	500	550	600	650	715	765	815	865
B	260	280	310	330	380	430	480	530	580	630	680	730	795	845	995	945
B	140	150	165	175	200	225	250	275	300	325	350	375	408	433	458	483

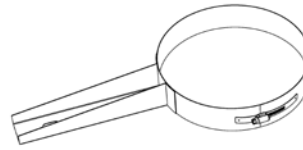
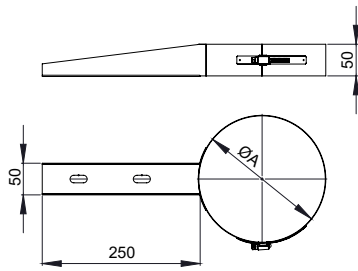

**Abrazadera forjado inox**

DW2562

Ø	130	150	180	200	250	300	350
ØA	180	200	230	250	300	350	400

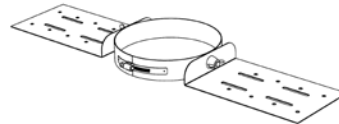
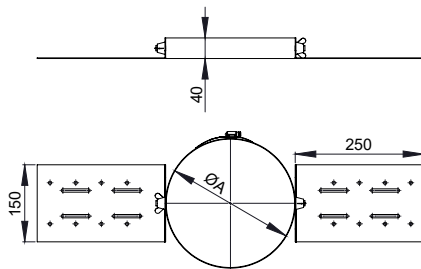

**Soporte de techo**

DW25936 - Ø80-Ø600

DW32936 - Ø650-Ø800

Ø	130	150	180	200	250	300	350	400	450	500	550	600	650	700	750	800
ØA	180	200	230	250	300	350	400	450	500	550	600	650	715	765	815	865

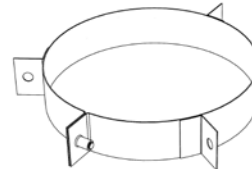
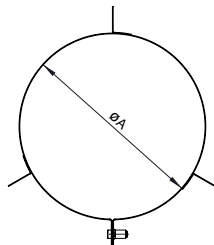

**Abrazadera vientos**

DW2542 - Ø80-Ø600

DW32942 - Ø650-Ø800

Ø	130	150	180	200	250	300	350	400	450	500	550	600	650	700	750	800
ØA	180	200	230	250	300	350	400	450	500	550	600	650	715	765	815	865

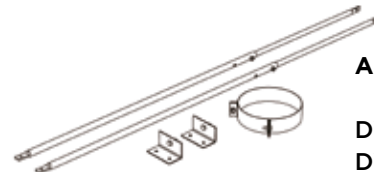
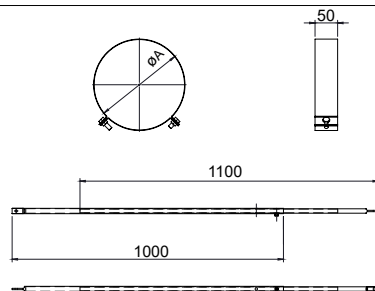

**Abr. con doble pertiga telescópica**

DW25191 - Ø80-Ø600

DW32191 - Ø650-Ø800

Ø	130	150	180	200	250	300	350	400	450	500	550	600	650	700	750	800
ØA	180	200	230	250	300	350	400	450	500	550	600	650	715	765	815	865

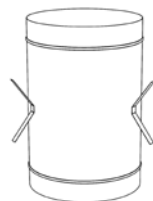
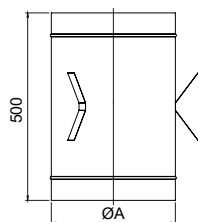

**Pasamuros**

DW25987 - Ø80-Ø600  
DW32987 - Ø650-Ø800

Ø	130	150	180	200	250	300	350	400	450	500	550	600	650	700	750	800
ØA	210	230	260	280	330	380	430	480	530	580	630	680	745	795	845	895

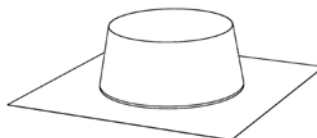
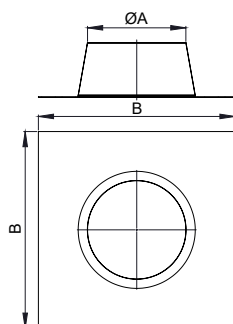

**Cubreaguas plano inox**

DW251128 - Ø80-Ø600  
DW321128 - Ø650-Ø800

Ø	130	150	180	200	250	300	350	400	450	500	550	600	650	700	750	800
ØA	210	230	260	280	330	380	430	480	535	585	635	685	750	800	850	900
B	470	490	520	540	590	640	690	740	795	845	895	945	1000	1050	1000	1050

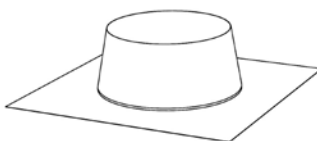
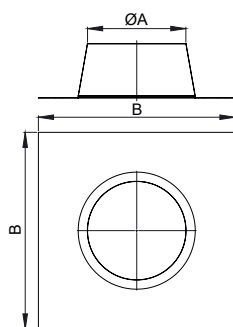

**Cubreaguas plomo 0°-5°**

DW25937 - Ø80-Ø600  
DW32937 - Ø650-Ø800

Ø	130	150	180	200	250	300	350	400	450	500	550	600	650	700	750	800
ØA	210	230	260	280	330	380	430	480	535	585	635	685	750	800	850	900
B	470	490	520	540	590	640	690	740	795	845	895	945	1000	1050	1000	1050

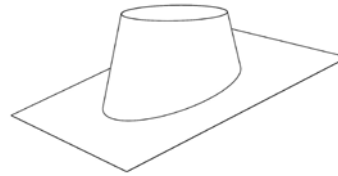
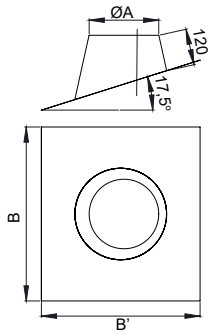

**Cubreaguas plomo 5°-25°**

DW25938 Ø80-Ø600  
DW32938 - Ø650-Ø800

Ø	130	150	180	200	250	300	350	400	450	500	550	600	650	700	750	800
ØA	210	230	260	280	330	380	430	480	535	585	635	685	750	800	850	900
B								1000	1100	1200	1300	1400	1000			
B'								1200	1200	1300	1400	1400	1000			

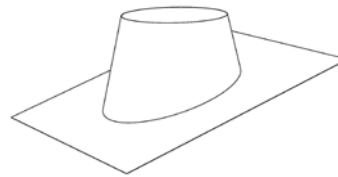
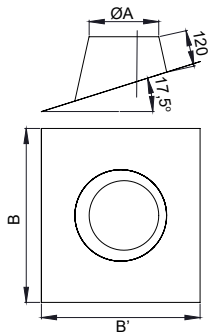

**Cubreaguas aluminio 5°-25°**

DW25938AL Ø80-Ø600  
DW32938AL - Ø650-Ø800

Ø	130	150	180	200	250	300	350	400	450	500	550	600	650	700	750	800	
ØA	210	230	260	280	330	380	430	480	535	585	635	685	750	800	850	900	
B								1000			1100	1200	1250	1300			
B'	1000							1200	1200	1300	1400	1400	1500	1500	1500	1500	

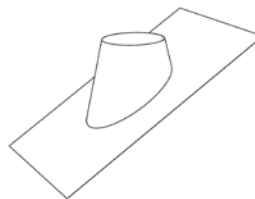
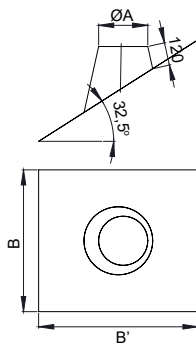

**Cubreaguas plomo 25°-45°**

DW25939 - Ø80-Ø600  
DW32939 - Ø650-Ø800

Ø	130	150	180	200	250	300	350	400	450	500	550	600	650	700	750	800
ØA	210	230	260	280	330	380	430	480	535	585	635	685	750	800	850	900
B								1100	1100	1200	1300	1300	1500			
B'	1000							1200	1200	1300	1400	1400	1500			

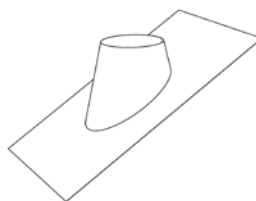
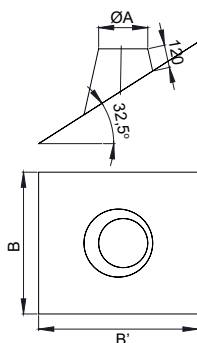

**Cubreaguas aluminio 25°-45°**

DW25939AL - Ø80-Ø600

DW32939AL - Ø650-Ø800

Ø	130	150	180	200	250	300	350	400	450	500	550	600	650	700	750	800	
ØA	210	230	260	280	330	380	430	480	535	585	635	685	750	800	850	900	
B									1100	1100	1200	1300	1300	1500			
B'	1000								1200	1200	1300	1400	1400	1500			

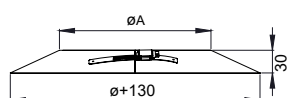

**Collarín antitormenta**

DW25307 - Ø80-Ø600

DW32307 - Ø650-Ø800

Ø	130	150	180	200	250	300	350	400	450	500	550	600	650	700	750	800
ØA	180	200	230	250	300	350	400	450	500	550	600	650	715	765	815	865

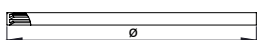

**Junta de silicona**

DW2526

Ø	130	150	180	200	250	300	350	400	450	500	550	600	650	700	750	800
---	-----	-----	-----	-----	-----	-----	-----	-----	-----	-----	-----	-----	-----	-----	-----	-----